

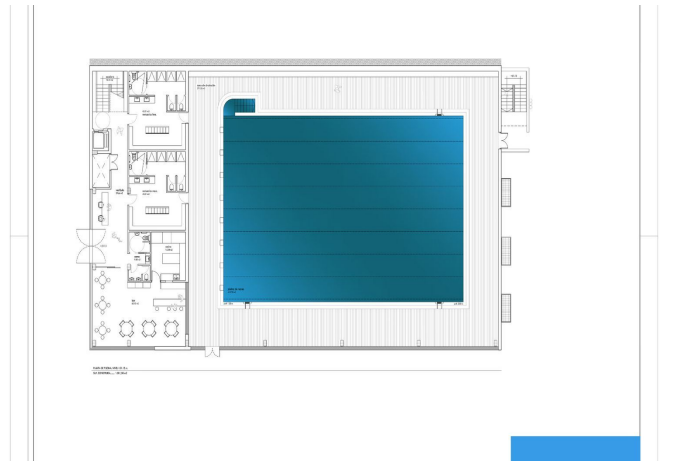

## Commercial Premises for sale in Benalmádena, Benalmádena

**3,500,000 €**

Reference: R5073979 Plot Size: 5,000m<sup>2</sup> Build Size: 3,000m<sup>2</sup>





## Costa del Sol, Benalmádena

Benalmádena Multi-Use Development Opportunity Built Size: approx. 3,000 m<sup>2</sup> | Plot: approx. 5,000 m<sup>2</sup> | Levels: 3–4 floors + rooftop Status: 70% Constructed | Customisable Final Layout A rare chance to acquire a substantial, partially completed commercial property in one of the most sought-after zones of Benalmádena – just minutes from the coast and neighbouring a leading international school. This architecturally striking building spans multiple levels with sea views, and is primed for a variety of commercial uses, including: Boutique hotel or co-living concept Wellness & fitness centre Private medical or rehabilitation facility Retail with lifestyle café/restaurant hub Event, co-working or education centre Current plans include: Vast indoor swimming pool – the largest private pool of its kind in the area Open-plan gym, spa, and treatment area. Multi-use studio rooms (yoga, pilates, dance, seminars) Two-level rooftop restaurant with panoramic sea views Landscaped garden area with sun beds and seating Secure access and potential for extensive parking in collaboration with the school Approximately 70% complete, with an estimated €1.5M needed to finish – this gives investors or operators the freedom to shape the final layout and finishes to match their business vision or branding. The property benefits from: Share sale structure – eliminating property transfer tax (ITP) Proximity to a large, international student and family population Outstanding visibility from surrounding residential and tourist areas Strong long-term ROI potential in a region with limited high-spec commercial offerings Whether you're seeking a flagship location for a hospitality or leisure brand, or an adaptable commercial asset in a growing area, this opportunity provides scale, design flexibility, and a prime coastal setting. Full business plan and conceptual designs available on request.



## Features:

### Orientation

South

### Views

Sea

Mountain

Pool

### Setting

Commercial Area

Close To Golf

Close To Sea

Close To Shops

Close To Schools

Marina

### Pool

Private

### Category

Investment

Resale

With Planning Permission